

# £149,995

## Mersey Road, Redcar, TS10



- Semi-Detached
- Three Bedrooms
- Kitchen/Diner
- Lounge
- Downstairs Toilet
- Bathroom
- Front & Rear Gardens
- Driveway
- No Onward Chain

### **3 Bedroom Semi-Detached House - Mersey Road, Redcar**

Offered for sale with no onward chain, this well-presented three-bedroom home is situated within a popular residential area of Redcar, making it an ideal purchase for first time buyers, families and commuters alike.

The property briefly comprises an entrance hallway leading to a convenient downstairs WC, a modern kitchen/diner fitted with a range of white gloss units and integrated appliances,

and a spacious lounge with French patio doors opening onto the rear garden. This creates a bright and versatile living space suited to both everyday living and entertaining.

To the first floor are three well-proportioned bedrooms and a family bathroom featuring a bath with shower over, pedestal sink, and WC. The main bedroom benefits from built-in storage and double wardrobes, providing excellent practicality.

Externally, the property offers a driveway and a lawned area to the front. To the rear is a fully enclosed garden, mainly laid to lawn with a decking area and a shed, ideal for outdoor use and low-maintenance living.

This property is well positioned for access to a range of local amenities. There are a number of primary and secondary schools within walking distance nearby, making the location particularly appealing for families. A selection of local convenience stores and supermarkets are within easy reach, ensuring everyday essentials are readily available. The area benefits from good local bus links providing access to Redcar town centre and surrounding areas. There is also excellent access to the A174 and A66, making commuting to Middlesbrough and the wider Teesside area straightforward.

A fantastic opportunity to purchase a modern and well-located home with no onward chain, offering spacious accommodation, outdoor space, and excellent transport connections. Ideal for first-time buyers, families, or investors.

# Mersey Road, Redcar, TS10

## Entrance Hallway

7'3" x 3'7" (2.21m x 1.09m)

Composite front door. Carpeted. Pendant light. Radiator. Smoke detector. Thermostat. Stairs leading to the first floor, with the WC, kitchen, and lounge leading off.

## Downstairs Toilet

3'2" x 4'7" (0.97m x 1.40m)

Vinyl flooring. Pedestal sink and a toilet with a push-button flush. Radiator. Consumer unit.

## Kitchen/Diner

13'6" x 11'5" (4.11m x 3.48m)

Vinyl flooring. Radiator and wall-mounted heating controls. White gloss base and wall-mounted units with chrome handles, paired with Formica worktops. Gas hob with a stainless steel splashback and extractor fan. Indesit oven. Integrated fridge and freezer. Integrated Kenwood washing machine. Integrated Indesit dishwasher. Stainless steel sink with drainer and mixer tap. Roller blind. Door leading through to the lounge.

## Lounge

11'4" x 14'7" (3.45m x 4.45m)

Carpeted. Radiator. Under-stairs storage cupboard. Venetian blinds. French patio doors opening out to the rear garden.

## Stairs & Landing

Carpeted. Radiator. Loft hatch; all bedrooms and the family bathroom lead off.

## Bedroom 1

12'7" x 9'6" (3.84m x 2.90m)

Carpeted. Radiator and wall-mounted thermostat. Built-in storage cupboard and double wardrobes. Curtains.

## Bedroom 2

9'7" x 8'4" (2.92m x 2.54m)

Carpeted. Radiator. Curtains.

## Bedroom 3

6'6" x 5'9" (1.98m x 1.75m)

Carpeted. Radiator. Roller blind.

## Bathroom

8'4" x 5'4" (2.54m x 1.63m)

Vinyl flooring. Radiator. Bath with a shower running off the mixer taps, set on a riser rail with a glazed screen. Pedestal sink. Toilet with a push-button flush. Extractor fan.

## Front Garden & Driveway

Driveway. Lawn area.

## Rear Garden

Fully enclosed. Decking area. Mainly laid to lawn. Garden shed.

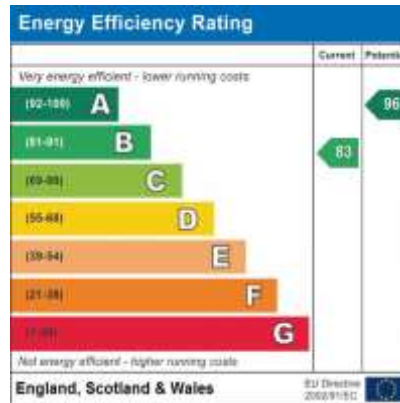







GROUND FLOOR

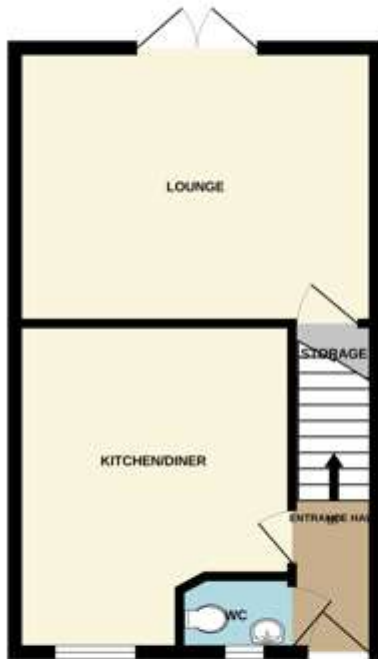

1ST FLOOR



While every attempt has been made to ensure the accuracy of the floorplans contained here, measurements of doors, windows, rooms and any other items are approximate and no responsibility is taken for any error, omission or false statement. This plan is for illustrative purposes only and should not be used as such for any prospective purchase. The fixtures, fittings and appliances shown here are not shown to scale and no guarantee as to their operability or efficiency can be given.  
 Made with Floorplan 12.0.0.0

## Directions

## Location



### VIEWING BY APPOINTMENT WITH AGENTS REDCAR LETTINGS & SALES COMPANY LTD

Exchange Buildings, 17-19 Cleveland Street, Redcar, TS10 1AR T: 01642 483430 E: [info@redcarletting.co.uk](mailto:info@redcarletting.co.uk) W: [redcarlettingandsales.co.uk](http://redcarlettingandsales.co.uk)

General: While we endeavour to make our sales particulars fair, accurate and reliable, they are only a general guide to the property and, accordingly, if there is any point which is of particular importance to you, please contact the office and we will be pleased to check the position for you, especially if you are contemplating travelling some distance to view the property.

Measurements: These approximate room sizes are only intended as general guidance. You must verify the dimensions carefully before ordering carpets or any built-in furniture.

Services: Please note we have not tested the services or any of the equipment or appliances in this property, accordingly we strongly advise prospective buyers to commission their own survey or service reports before finalizing their offer to purchase.

THESE PARTICULARS ARE ISSUED IN GOOD FAITH BUT DO NOT CONSTITUTE REPRESENTATIONS OF FACT OR FORM PART OF ANY OFFER OR CONTRACT. THE MATTERS REFERRED TO IN THESE PARTICULARS SHOULD BE INDEPENDENTLY VERIFIED BY PROSPECTIVE BUYERS OR TENANTS. NEITHER REDCAR LETTINGS & SALES COMPANY LTD NOR ANY OF ITS EMPLOYEES OR AGENTS HAS ANY AUTHORITY TO MAKE OR GIVE ANY REPRESENTATION OR WARRANTY WHATEVER IN RELATION TO THIS PROPERTY.

YOUR HOME IS AT RISK IF YOU DO NOT KEEP UP REPAYMENTS ON A MORTGAGE OR OTHER LOAN SECURED ON IT.

Written quotations available on request. All loans secured on property. Life assurance is usually required.