

## **Offers in excess of £600,000**

### **Hemstal Road, West Hampstead, NW6**



- Beautifully Presented
- Share of Freehold
- Peaceful Residential Road
- Convenient Location
- Wood Floors
- Excellent Natural Light
- En-suite bathroom
- Two double bedrooms
- Top Floor

Nestled in the vibrant heart of West Hampstead, this bright and generously proportioned top-floor apartment effortlessly combines contemporary design with everyday practicality. Featuring two double bedrooms and two sleek bathrooms, the home offers both comfort and style.

The inviting open-plan kitchen and living area comes complete with a dedicated dining space—perfect for entertaining guests or enjoying quiet evenings in. Both bedrooms are well-sized, with the principal suite boasting a stylish en-suite shower room, while a second fully tiled bathroom serves the rest of the flat.







## Hemstal Road, NW6

Approx. Gross Internal Area 646 Sq Ft - 60.01 Sq M

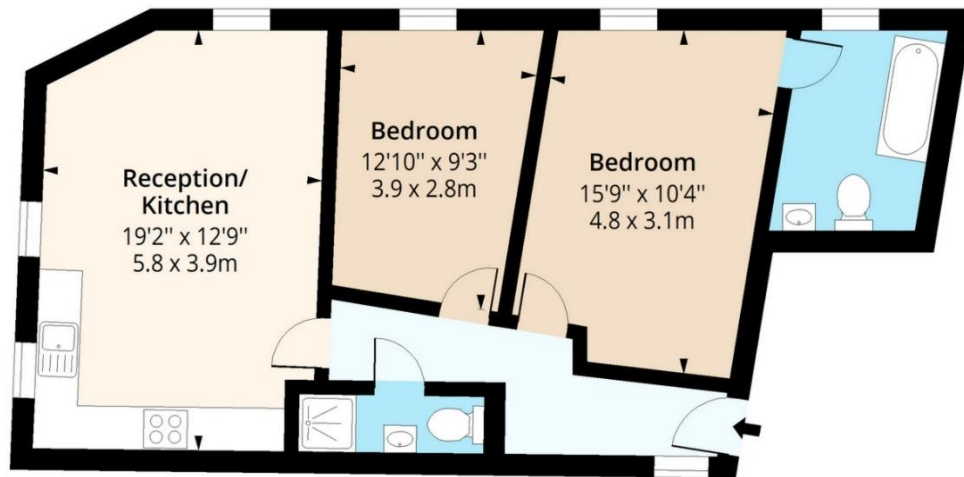
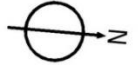

### Third Floor

Floor Area 646 Sq Ft - 60.01 Sq M



Measured according to RICS IPMS2. Floor plan is for illustrative purposes only and is not to scale. Every attempt has been made to ensure the accuracy of the floor plan shown, however all measurements, fixtures, fittings and data shown are an approximate interpretation for illustrative purposes only. 1 sq m = 10.76 sq feet.

lpaplus.com

Date: 8/7/2025

Directions

Location



VIEWING BY APPOINTMENT WITH AGENTS ROCHESTER PLACE

161 Kentish Town Road,Camden,London,NW1 8PD    T: 020 7284 4747    E: info@rochesterplace.co.uk    W: www.rochesterplace.co.uk

General: While we endeavour to make our sales particulars fair, accurate and reliable, they are only a general guide to the property and, accordingly, if there is any point which is of particular importance to you, please contact the office and we will be pleased to check the position for you, especially if you are contemplating travelling some distance to view the property.

Measurements: These approximate room sizes are only intended as general guidance. You must verify the dimensions carefully before ordering carpets or any built-in furniture. Services: Please note we have not tested the services or any of the equipment or appliances in this property, accordingly we strongly advise prospective buyers to commission their own survey or service reports before finalizing their offer to purchase.

THESE PARTICULARS ARE ISSUED IN GOOD FAITH BUT DO NOT CONSTITUTE REPRESENTATIONS OF FACT OR FORM PART OF ANY OFFER OR CONTRACT. THE MATTERS REFERRED TO IN THESE PARTICULARS SHOULD BE INDEPENDENTLY VERIFIED BY PROSPECTIVE BUYERS OR TENANTS. NEITHER ROCHESTER PLACE NOR ANY OF ITS EMPLOYEES OR AGENTS HAS ANY AUTHORITY TO MAKE OR GIVE ANY REPRESENTATION OR WARRANTY WHATEVER IN RELATION TO THIS PROPERTY. YOUR HOME IS AT RISK IF YOU DO NOT KEEP UP REPAYMENTS ON A MORTGAGE OR OTHER LOAN SECURED ON IT.

Written quotations available on request. All loans secured on property. Life assurance is usually required.