



SEYMOURGREEN

AT THE HEART ♥ OF YOUR MOVE

Wimbledon Park Road, Southfields, London, SW18

- ♥ Two Double Bedrooms
- ♥ Walking Distance to Southfields Tube
- ♥ Private Garden
- ♥ Good Order Throughout
- ♥ Excellent Location
- ♥ Spacious Living Room

Perfectly located TWO DOUBLE BEDROOM first floor flat within easy walking distance to SOUTHFIELDS TUBE STATION and the shops, restaurants and bars of SOUTHFIELDS VILLAGE. The flat is in good order throughout, comes UNFURNISHED whilst also benefitting from a private REAR GARDEN.

To Let: £1,550 per month



Seymour Green, 483 Merton Road, London SW18 5LE

T: 020 8870 0111 F: 020 3302 9598 E: southfields@seymour-green.co.uk W: seymour-green.co.uk



SEYMOURGREEN

AT THE HEART  OF YOUR MOVE

WIMBLEDON PARK ROAD, SW18

Approx. Gross Internal Floor Area

595 Sq. ft/55.27 Sq. m

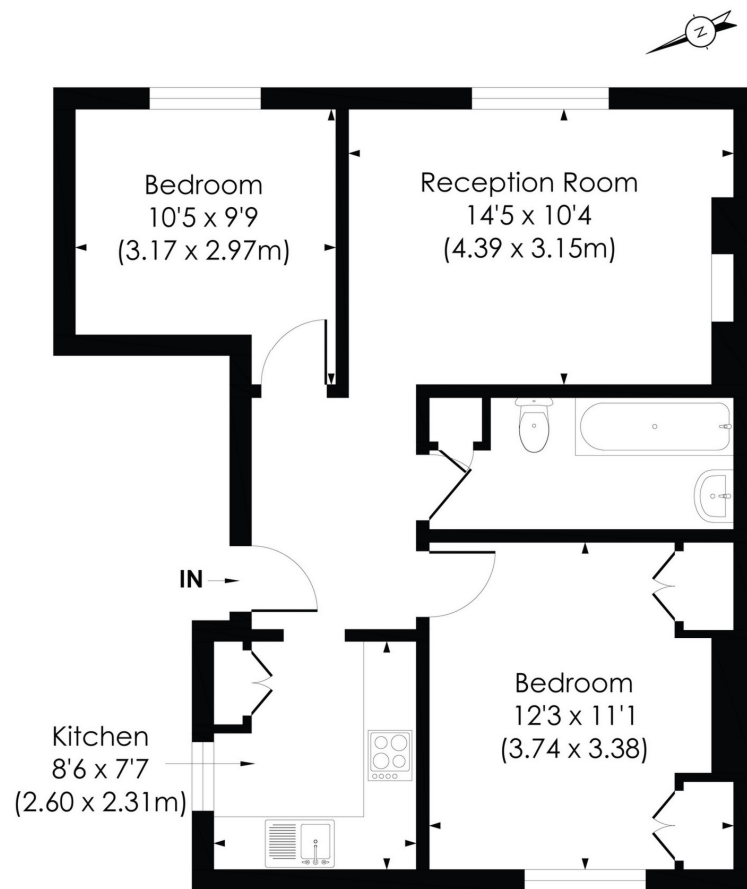

FIRST FLOOR

© Pixangle Property Marketing Ltd. info@pixangle.com Tel: 0208 870 2118

pixangle
PROPERTY MARKETING

This floor plan has been prepared for the purpose of illustration only in accordance with the latest RICS code of measuring practice and is not to scale. All measurements and areas are approximate and whilst every effort has been made to ensure the accuracy of the plan contained here, no responsibility is taken for any error, omission or misstatement.

Wimbledon Park Road, Southfields, London, SW18

To Let: £1,550 per month



Wimbledon Park Road, Southfields, London, SW18

To Let: £1,550 per month

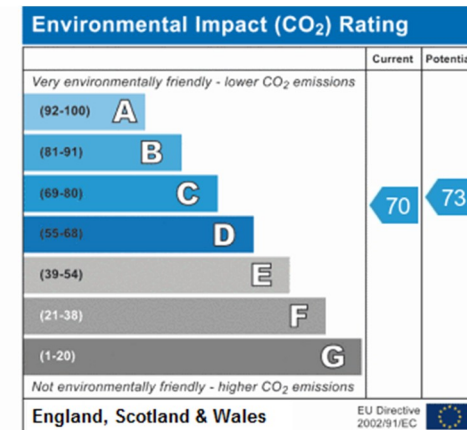
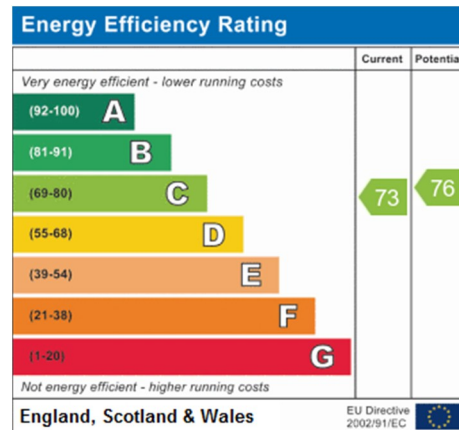

IMPORTANT NOTICE
Descriptions of the property are subjective and are used in good faith as an opinion and NOT as a statement of fact. Please make further specific enquires to ensure that our descriptions are likely to match any expectations you may have of the property. We have not tested any services, systems or appliances at this property. We strongly recommend that all the information we provide be verified by you on inspection, and by your Surveyor and Conveyancer.

Seymour Green, 483 Merton Road, London SW18 5LE
T: 020 8870 0111 F: 020 3302 9598 E: southfields@seymour-green.co.uk W: seymour-green.co.uk