



SEYMOURGREEN
AT THE HEART ♥ OF YOUR MOVE

Burfield Close, Tooting, London, SW17

- ♥ Immaculate Condition
- ♥ Large Communal Garden
- ♥ Walking Distance to Tooting Broadway
- ♥ Extensive Built in Storage
- ♥ Off Street Parking
- ♥ Spacious Living Room

A fabulous opportunity to purchase a stunning ground floor flat forming part of this small development set within this pleasant cul de sac where properties very rarely become available. The ground floor entrance opens onto the hallway with excellent storage, with the modern bathroom and well fitted kitchen to the front, the south facing double bedroom with built in wardrobes and lovely living room both overlook the large communal gardens to the rear. The development can be accessed by foot via the Alms Houses Gardens on Garratt Lane or by car from Wimbledon Road, Tooting Broadway Tube Station is a 12 minute walk, Haydons Road Overground Station is a 15 minute walk, whilst there are several local bus routes on Garratt Lane and Wimbledon Road.



For Sale: £285,000

Seymour Green, 483 Merton Road, London SW18 5LE

T: 020 8870 0111 F: 020 3302 9598 E: southfields@seymour-green.co.uk W: seymour-green.co.uk



SEYMOURGREEN
AT THE HEART ♥ OF YOUR MOVE

BURFIELD CLOSE, SW17

Approx. Gross Internal Floor Area

483 Sq. ft/44.89 Sq. m

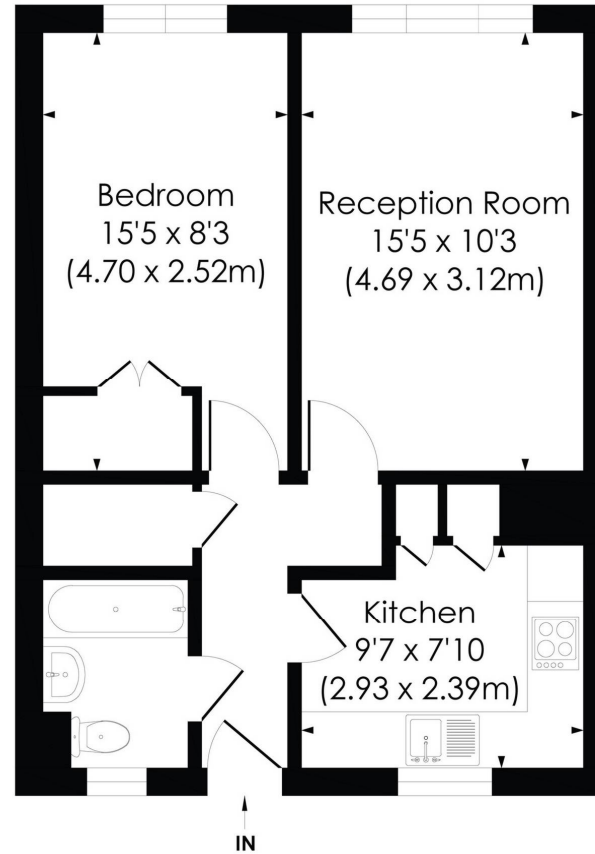

GROUND FLOOR

© Pixangle Property Marketing Ltd. info@pixangle.com Tel: 0208 870 2118

pixangle
PROPERTY MARKETING

This floor plan has been prepared for the purpose of illustration only in accordance with the latest RICS code of measuring practice and is not to scale. All measurements and areas are approximate and whilst every effort has been made to ensure the accuracy of the plan contained here, no responsibility is taken for any error, omission or misstatement.



SEYMOURGREEN
AT THE HEART ♥ OF YOUR MOVE

Burfield Close, Tooting, London, SW17

For Sale: £285,000



Seymour Green, 483 Merton Road, London SW18 5LE
T: 020 8870 0111 F: 020 3302 9598 E: southfields@seymour-green.co.uk W: seymour-green.co.uk



SEYMOURGREEN
AT THE HEART OF YOUR MOVE

Burfield Close, Tooting, London, SW17

For Sale: £285,000

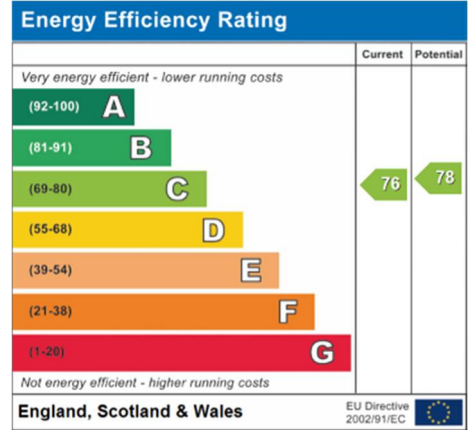

IMPORTANT NOTICE
Descriptions of the property are subjective and are used in good faith as an opinion and NOT as a statement of fact. Please make further specific enquires to ensure that our descriptions are likely to match any expectations you may have of the property. We have not tested any services, systems or appliances at this property. We strongly recommend that all the information we provide be verified by you on inspection, and by your Surveyor and Conveyancer.

Seymour Green, 483 Merton Road, London SW18 5LE
T: 020 8870 0111 F: 020 3302 9598 E: southfields@seymour-green.co.uk W: seymour-green.co.uk