



SEYMOURGREEN

AT THE HEART ♥ OF YOUR MOVE

Greyhound Parade, Wimbledon, London, SW17

- ♥ No Onward Chain
- ♥ Private Balcony
- ♥ 244 Year Lease
- ♥ Large Living Space
- ♥ Stunning Views
- ♥ Ideal First Time Buy

A Stunning 6th Floor apartment boasting the most amazing views over AFC Wimbledon Stadium, where match days will never be the same! Set within this highly regarded development constructed just over 3 years ago this spacious apartment with large open plan living space and well fitted kitchen with integrated appliances, generous double bedroom, stylish bathroom, good storage and a fabulous balcony would make the ideal first time buy. Millwards Court is very well located with excellent transport facilities with regular bus services to Wimbledon and Tooting, whilst there the more immediate area offers supermarkets, coffee shops and gyms on the door step.

For Sale: £425,000



Seymour Green, 483 Merton Road, London SW18 5LE

T: 020 8870 0111 F: 020 3302 9598 E: southfields@seymour-green.co.uk W: seymour-green.co.uk



SEYMOURGREEN

AT THE HEART ♥ OF YOUR MOVE

GREYHOUND PARADE, SW17

Approx. Gross Internal Floor Area

572 Sq. ft/53.10 Sq. m

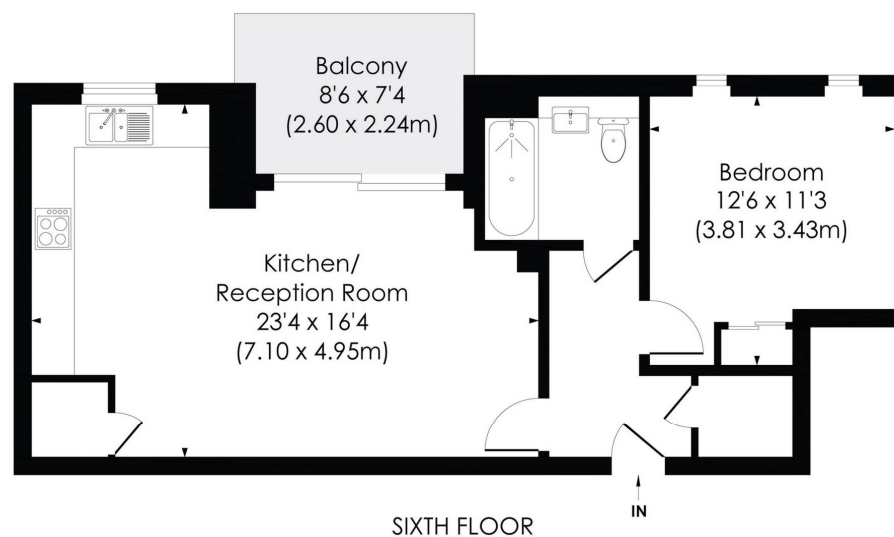

© Pixangle Property Marketing Ltd. info@pixangle.com Tel: 0208 870 2118

pixangle
PROPERTY MARKETING

This floor plan has been prepared for the purpose of illustration only in accordance with the latest RICS code of measuring practice and is not to scale. All measurements and areas are approximate and whilst every effort has been made to ensure the accuracy of the plan contained here, no responsibility is taken for any error, omission or misstatement.

Greyhound Parade, Wimbledon, London, SW17

For Sale: £425,000



Seymour Green, 483 Merton Road, London SW18 5LE
T: 020 8870 0111 F: 020 3302 9598 E: southfields@seymour-green.co.uk W: seymour-green.co.uk



SEYMOURGREEN

AT THE HEART ♥ OF YOUR MOVE

Greyhound Parade, Wimbledon, London, SW17

For Sale: £425,000

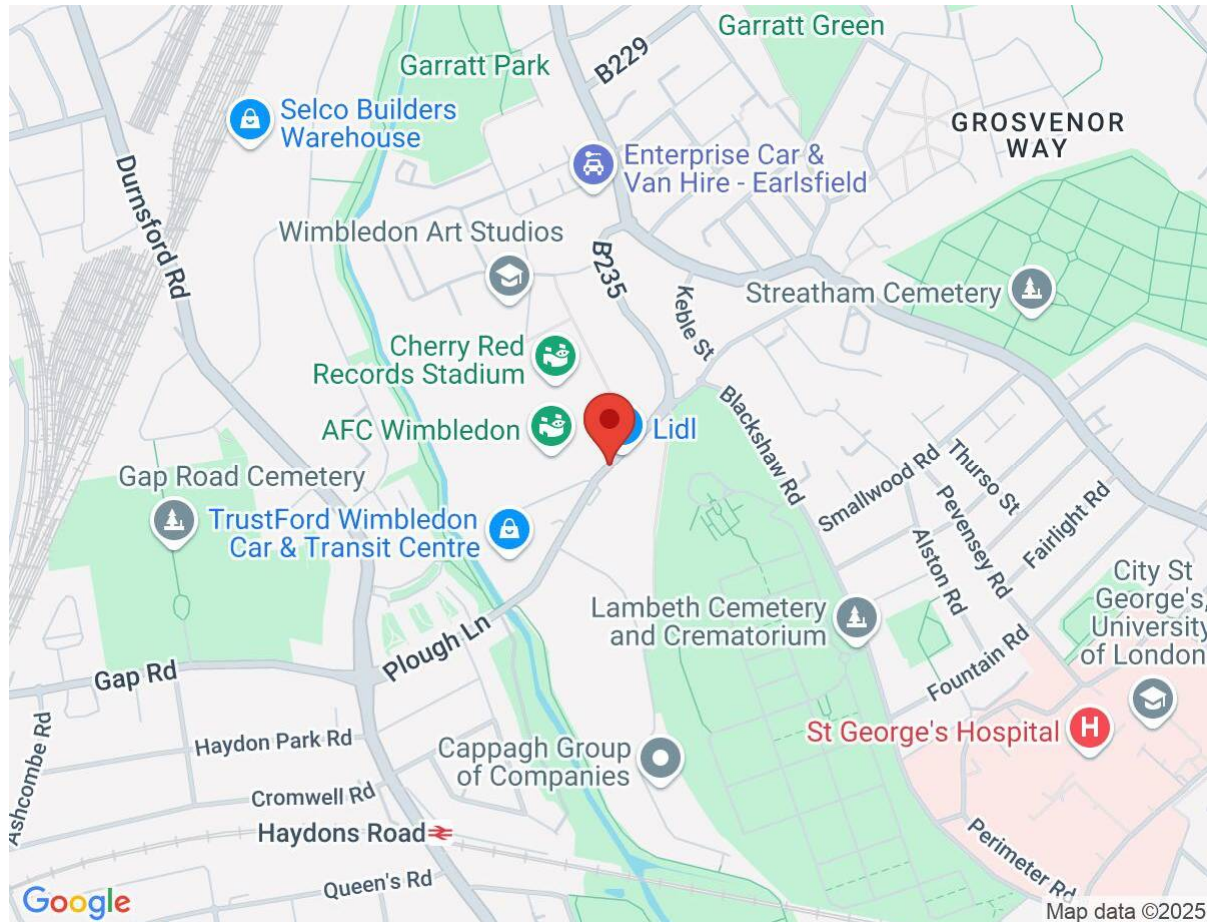

IMPORTANT NOTICE

Descriptions of the property are subjective and are used in good faith as an opinion and NOT as a statement of fact. Please make further specific enquires to ensure that our descriptions are likely to match any expectations you may have of the property. We have not tested any services, systems or appliances at this property. We strongly recommend that all the information we provide be verified by you on inspection, and by your Surveyor and Conveyancer.

Energy Efficiency Rating		
	Current	Potential
Very energy efficient - lower running costs		
(92-100) A		
(81-91) B	84	84
(69-80) C		
(55-68) D		
(39-54) E		
(21-38) F		
(1-20) G		
Not energy efficient - higher running costs		
England, Scotland & Wales		
EU Directive 2002/91/EC		



Seymour Green, 483 Merton Road, London SW18 5LE

T: 020 8870 0111 F: 020 3302 9598 E: southfields@seymour-green.co.uk W: seymour-green.co.uk