



College Way, Hayes, UB3

£315,000 Leasehold

PERFECT LOCATION!!! Simple Estate Agents present to the market this two bed flat The property benefits from a large living space with dining area, good size kitchen, two double bedrooms and a family bathroom, ample storage, telephone entry system and lift service. The property is located in a quiet residential area, with easy access to local amenities. The best way to imagine yourself living in this great property is by booking a viewing...

College Way, Hayes, UB3

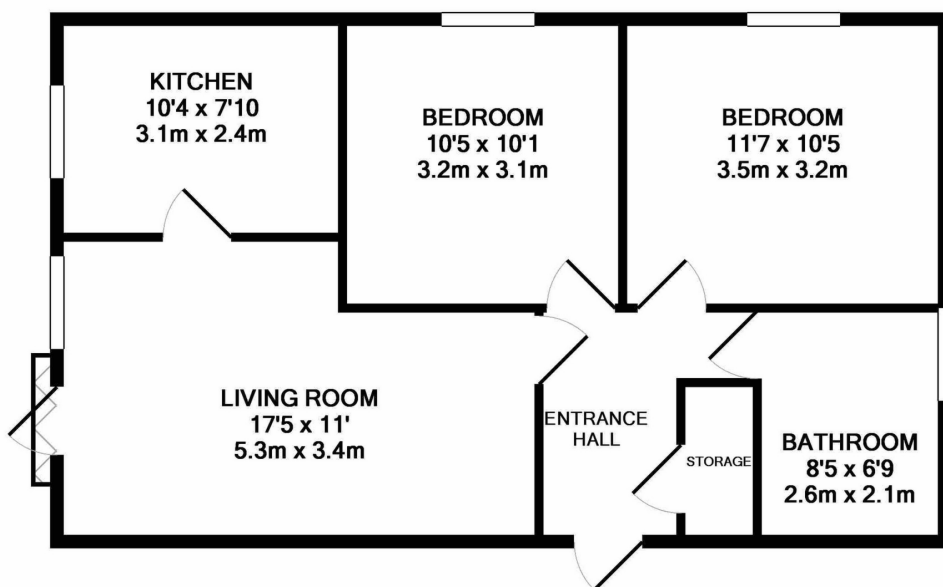

TOTAL APPROX. FLOOR AREA 604 SQ.FT. (56.1 SQ.M.)

Whilst every attempt has been made to ensure the accuracy of the floor plan contained here, measurements of doors, windows, rooms and any other items are approximate and no responsibility is taken for any error, omission, or mis-statement. This plan is for illustrative purposes only and should be used as such by any prospective purchaser. The services, systems and appliances shown have not been tested and no guarantee as to their operability or efficiency can be given
Made with Metropix ©2019



Energy Efficiency Rating		Current	Potential
<i>Very energy efficient - lower running costs</i>			
(92-100)	A		
(81-91)	B		
(69-80)	C	79	81
(55-68)	D		
(39-54)	E		
(21-38)	F		
(1-20)	G		
<i>Not energy efficient - higher running costs</i>			
England, Scotland & Wales		EU Directive 2002/91/EC	

Directions

UB3 3ES Coldharbour Ln, Hayes Head north-east towards Hunters Grove 194 ft
Turn left onto Hunters Grove 128 ft Turn right onto Coldharbour Ln 0.5 mi Turn left onto College Way Destination will be on the right 0.1 mi UB3 3DZ College Way, Hayes

Environmental Impact (CO ₂) Rating		Current	Potential
<i>Very environmentally friendly - lower CO₂ emissions</i>			
(92-100)	A		
(81-91)	B		
(69-80)	C	76	79
(55-68)	D		
(39-54)	E		
(21-38)	F		
(1-20)	G		
<i>Not environmentally friendly - higher CO₂ emissions</i>			
England, Scotland & Wales		EU Directive 2002/91/EC	

General: While we endeavour to make our sales particulars fair, accurate and reliable, they are only a general guide to the property and, accordingly, if there is any point which is of particular importance to you, please contact the office and we will be pleased to check the position for you, especially if you are contemplating travelling some distance to view the property. Measurements: These approximate room sizes are only intended as general guidance. You must verify the dimensions carefully before ordering carpets or any built-in furniture. Services: Please note we have not tested the services or any of the equipment or appliances in this property, accordingly we strongly advise prospective buyers to commission their own survey or service reports before finalizing their offer to purchase. THESE PARTICULARS ARE ISSUED IN GOOD FAITH BUT DO NOT CONSTITUTE REPRESENTATIONS OF FACT OR FORM PART OF ANY OFFER OR CONTRACT. THE MATTERS REFERRED TO IN THESE PARTICULARS SHOULD BE INDEPENDENTLY VERIFIED BY PROSPECTIVE BUYERS OR TENANTS. NEITHER SIMPLE ESTATE AGENTS NOR ANY OF ITS EMPLOYEES OR AGENTS HAS ANY AUTHORITY TO MAKE OR GIVE ANY REPRESENTATION OR WARRANTY WHATSOEVER IN RELATION TO THIS PROPERTY.