



## £300,000 Leasehold

Waxlow House, Hornbeam Road, Hayes, UB4

Two-Bedroom First Floor Flat! This well-presented two-bedroom first-floor flat is conveniently located near Yeading Lane. The property features a spacious living room with views of the communal gardens. The kitchen is fully equipped with a gas cooker, dishwasher, washing machine, and fridge freezer. The family bathroom includes a panel-enclosed bath with a shower. Additional benefits include gas central heating and double-glazed windows for added comfort and energy efficiency. An ideal home for comfortable living.

# Waxlow House, Hornbeam Road, Hayes, UB4

## Waxlow House, Hornbeam Road, Hayes, UB4

Approximate Area = 673 sq ft / 62.5 sq m

For identification only - Not to scale

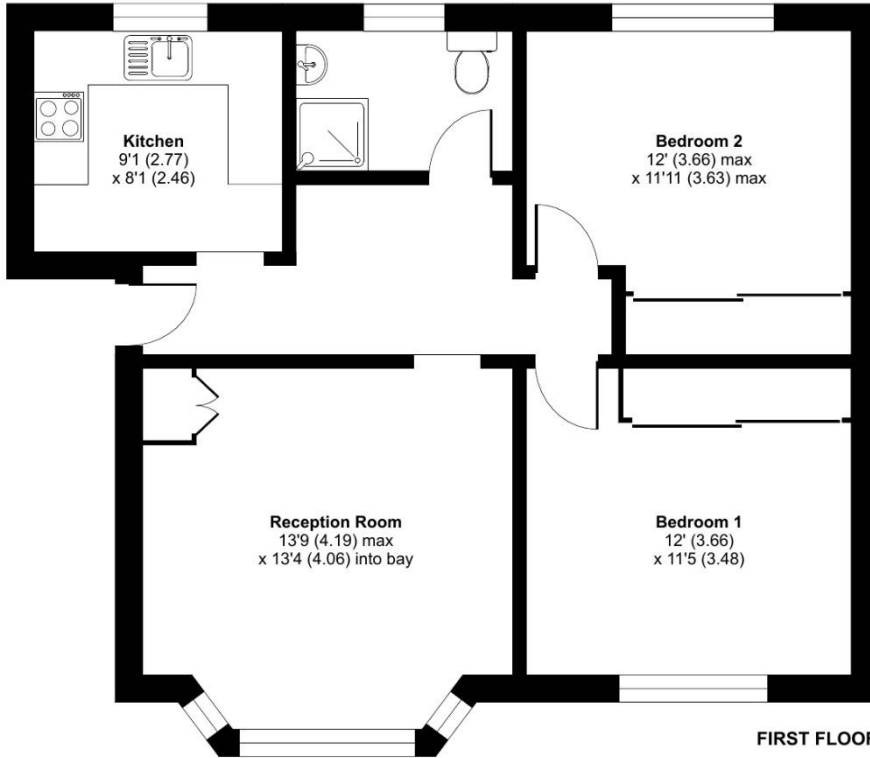

Floor plan produced in accordance with RICS Property Measurement 2nd Edition, Incorporating International Property Measurement Standards (IPMS2 Residential). © nchecon 2024. Produced for Simple Estate Agents. REF: 1219721

Energy Efficiency Rating		
	Current	Potential
Very energy efficient - lower running costs		
(92-100) <b>A</b>		
(81-91) <b>B</b>	<b>81</b>	<b>81</b>
(69-80) <b>C</b>		
(55-68) <b>D</b>		
(39-54) <b>E</b>		
(21-38) <b>F</b>		
(1-20) <b>G</b>		
Not energy efficient - higher running costs		
<b>England, Scotland &amp; Wales</b>		EU Directive 2002/91/EC

### Directions

UB3 3ES Coldharbour Ln, Hayes ? Take Pump Ln to The Pkwy/A312 3 min (0.8 mi)  
 ? Follow The Pkwy/A312 to Willow Tree Ln 2 min (1.5 mi) ? Continue on Willow Tree Ln. Drive to Hornbeam Rd 3 min (0.6 mi) UB4 9EF Hayes

Environmental Impact (CO <sub>2</sub> ) Rating		
	Current	Potential
Very environmentally friendly - lower CO <sub>2</sub> emissions		
(92-100) <b>A</b>		
(81-91) <b>B</b>	<b>81</b>	<b>81</b>
(69-80) <b>C</b>		
(55-68) <b>D</b>		
(39-54) <b>E</b>		
(21-38) <b>F</b>		
(1-20) <b>G</b>		
Not environmentally friendly - higher CO <sub>2</sub> emissions		
<b>England, Scotland &amp; Wales</b>		EU Directive 2002/91/EC

General: While we endeavour to make our sales particulars fair, accurate and reliable, they are only a general guide to the property and, accordingly, if there is any point which is of particular importance to you, please contact the office and we will be pleased to check the position for you, especially if you are contemplating travelling some distance to view the property. Measurements: These approximate room sizes are only intended as general guidance. You must verify the dimensions carefully before ordering carpets or any built-in furniture. Services: Please note we have not tested the services or any of the equipment or appliances in this property, accordingly we strongly advise prospective buyers to commission their own survey or service reports before finalizing their offer to purchase. THESE PARTICULARS ARE ISSUED IN GOOD FAITH BUT DO NOT CONSTITUTE REPRESENTATIONS OF FACT OR FORM PART OF ANY OFFER OR CONTRACT. THE MATTERS REFERRED TO IN THESE PARTICULARS SHOULD BE INDEPENDENTLY VERIFIED BY PROSPECTIVE BUYERS OR TENANTS. NEITHER SIMPLE ESTATE AGENTS NOR ANY OF ITS EMPLOYEES OR AGENTS HAS ANY AUTHORITY TO MAKE OR GIVE ANY REPRESENTATION OR WARRANTY WHATSOEVER IN RELATION TO THIS PROPERTY.