



£385,000 Leasehold

Homer Drive, London, E14

Fantastic 2-Bedroom Apartment in Cyclops Wharf! This well-presented second-floor apartment is part of the sought-after Cyclops Wharf development. The property offers a spacious reception room with wooden flooring, a separate fitted kitchen, two generous double bedrooms with ample storage, and a three-piece bathroom. Residents benefit from exclusive access to onsite amenities, including a swimming pool, gym, and 24-hour concierge service. Additional features include a video entry system and covered, allocated parking. Conveniently located near Canary Wharf's shopping and business district, this property is ideal for professionals or investors. A viewing is highly recommended.

Homer Drive, London, E14

Holmer Drive London E14 3UB

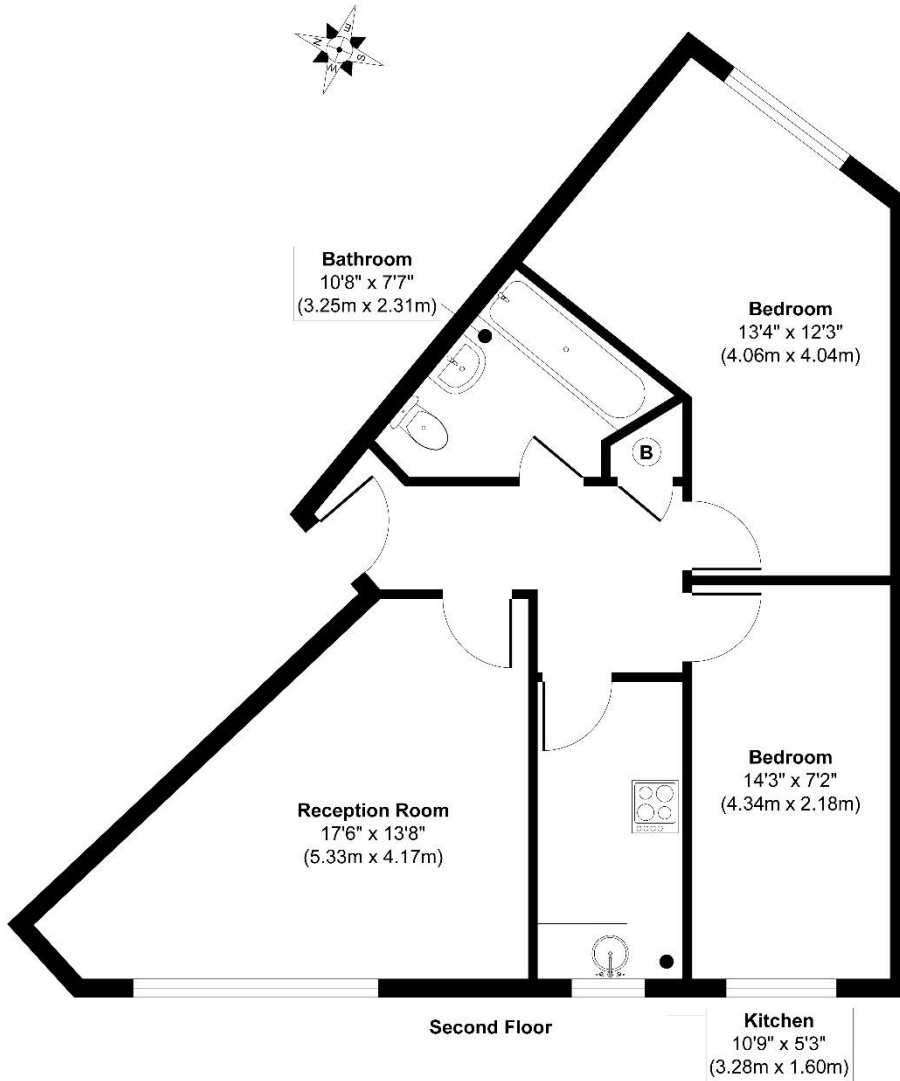

Approx. Gross Internal Floor Area 617 sq. ft / 57.32 sq. m

Illustration for identification purposes only, measurements are approximate, not to scale.

Produced by Elements Property



Energy Efficiency Rating		
	Current	Potential
Very energy efficient - lower running costs		
(92-100) A		
(81-91) B		
(69-80) C		
(55-68) D	59	67
(39-54) E		
(21-38) F		
(1-20) G		
Not energy efficient - higher running costs		
England, Scotland & Wales	EU Directive 2002/91/EC	

Environmental Impact (CO ₂) Rating		
	Current	Potential
Very environmentally friendly - lower CO ₂ emissions		
(92-100) A		
(81-91) B		
(69-80) C		
(55-68) D	59	67
(39-54) E		
(21-38) F		
(1-20) G		
Not environmentally friendly - higher CO ₂ emissions		
England, Scotland & Wales	EU Directive 2002/91/EC	

General: While we endeavour to make our sales particulars fair, accurate and reliable, they are only a general guide to the property and, accordingly, if there is any point which is of particular importance to you, please contact the office and we will be pleased to check the position for you, especially if you are contemplating travelling some distance to view the property. Measurements: These approximate room sizes are only intended as general guidance. You must verify the dimensions carefully before ordering carpets or any built-in furniture. Services: Please note we have not tested the services or any of the equipment or appliances in this property, accordingly we strongly advise prospective buyers to commission their own survey or service reports before finalizing their offer to purchase. THESE PARTICULARS ARE ISSUED IN GOOD FAITH BUT DO NOT CONSTITUTE REPRESENTATIONS OF FACT OR FORM PART OF ANY OFFER OR CONTRACT. THE MATTERS REFERRED TO IN THESE PARTICULARS SHOULD BE INDEPENDENTLY VERIFIED BY PROSPECTIVE BUYERS OR TENANTS. NEITHER SIMPLE ESTATE AGENTS NOR ANY OF ITS EMPLOYEES OR AGENTS HAS ANY AUTHORITY TO MAKE OR GIVE ANY REPRESENTATION OR WARRANTY WHATSOEVER IN RELATION TO THIS PROPERTY.