

FOR SALE

£1,055,000 Leasehold

Tafaders

Paddington Exchange, Hermitage Road, W2



1 Bedroom

1 Bathroom

1 Reception

A stunning one bedroom apartment set within the impressive Paddington Exchange development in the heart of Paddington. Occupying the 3rd floor, this contemporary apartment offers superb living space coupled with luxury interiors. This substantial accommodation benefits from a private terrace accessible from the reception area and the bedroom, a fully fitted bespoke kitchen with integral appliances and a dining area, and a modern bathroom with a three piece suite. Features also include comfort cooling, built-in wardrobes in the bedroom, video entryphone and underfloor heating within the bathroom. Residents within the development also benefit from on-site facilities to include; a residents lounge, communal roof terraces and a 24hr concierge service.

Paddington Exchange is located within one of the most well-connected areas in London, with an extensive overground and underground rail network offering excellent connectivity to The City, West End and Heathrow airport. Transport links will be further enhanced by the introduction of the Crossrail station at Paddington currently under construction with a sub-surface link to the concourse of Paddington's mainline station, due to complete in 2018.

w: www.tafaders.com

t: 0207 404 0039

e: info@tafaders.com

PHOTOS



FLOORPLAN

Tafaders

PADDINGTON EXCHANGE, HERMITAGE ROAD, PADDINGTON, W2

APPROX. GROSS INTERNAL FLOOR AREA 626 sq.ft (58.1 sq.m)

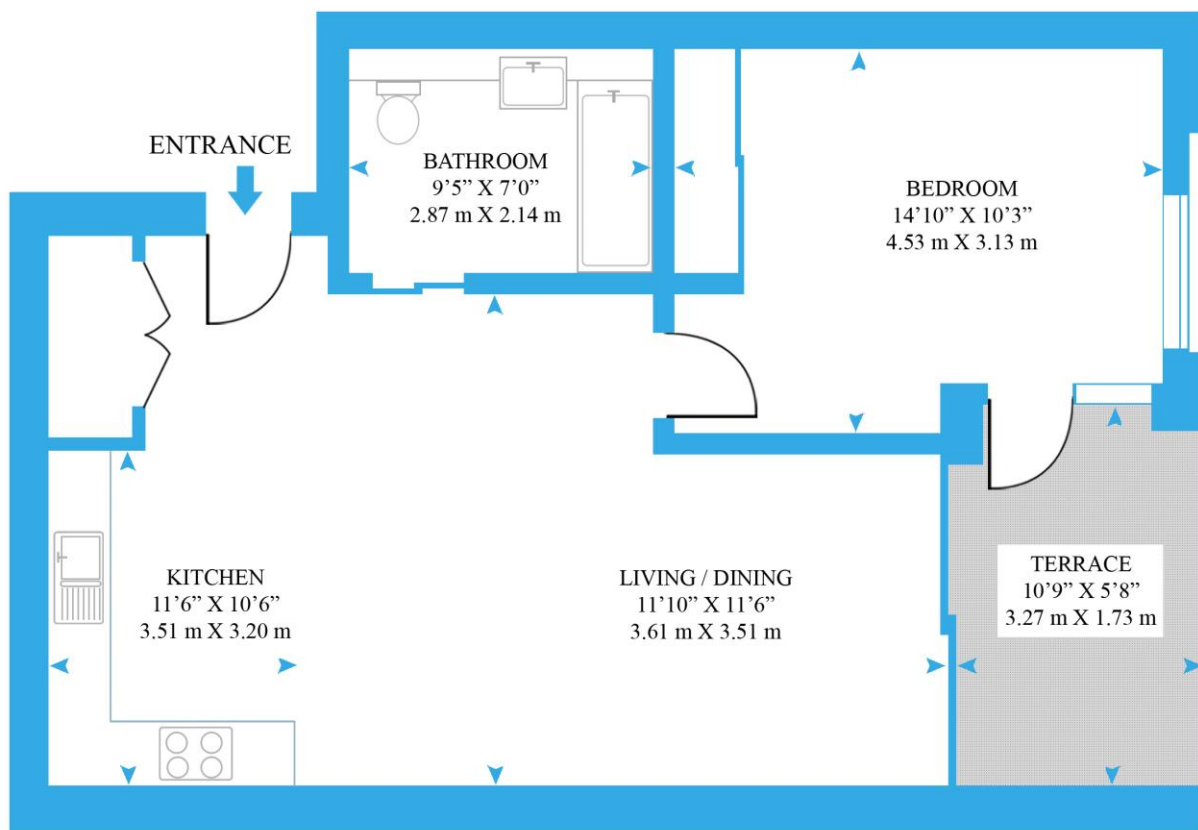
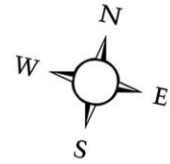

The Floor - plans are for representation purposes only and should be used as such by any prospective client.

L01234