

FOR SALE

£520,000 Leasehold

Tafaders

Vancouver House, Maple Quays, Canada Water, SE16



1 Bedroom

1 Bathroom

1 Reception

A contemporary one bedroom apartment with parking, set within the sought after Maple Quays development. This well appointed one bedroom apartment is arranged over the first floor of Vancouver House, measuring an impressive 575 Sq ft of living space. The apartment comprises an open plan reception room with fitted kitchen, a good sized double bedroom with fitted wardrobes, a luxury fitted bathroom and two private south facing balconies accessible from the reception room and the bedroom. Residents within the development also benefit from a 24hr concierge, a well equipped residents gymnasium and landscaped communal gardens.

Maple Quays is in the heart of Canada Water and is moments away from local amenities, including Surrey Quays shopping centre and its wide variety of shops. The local transport links are excellent, offering easy access to Canary Wharf, Greenwich and The City.

w: www.tafaders.com

t: 020 7537 2046

e: bowandcw@tafaders.com

PHOTOS



FLOORPLAN



VANCOUVER HOUSE, MAPLE QUAYS, SE16

APPROX. GROSS INTERNAL FLOOR AREA 575 sq.ft (53.42 sq.m)

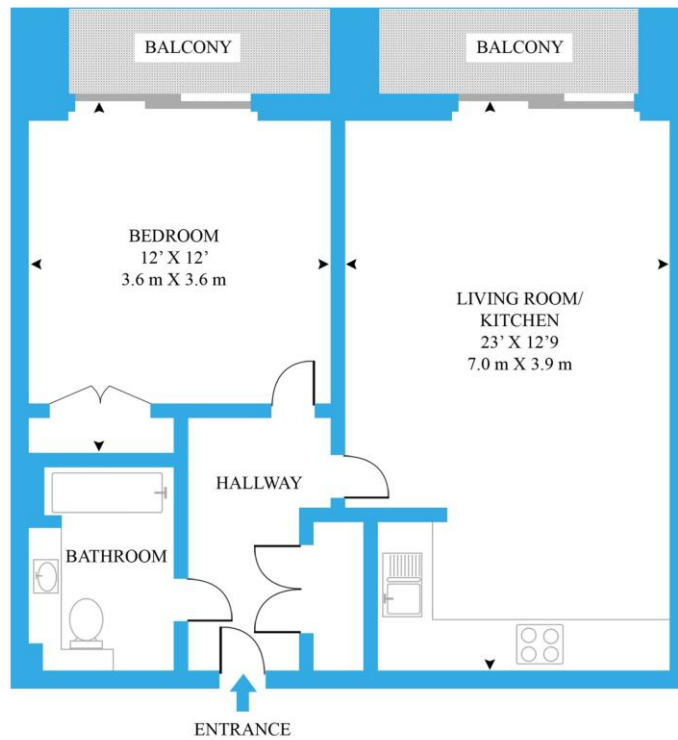

FIRST FLOOR

The Floor - plans are for representation purposes only and should be used as such by any prospective client.

L01204

